

Plan Information

| | |
|--------------|----------------|
| Tenure Type | Freehold |
| Plan Type | Deposited Plan |
| Plan Purpose | Subdivision |

Plan Heading

Lots1-27, Roads and Easements

Locality & Local Government

| | |
|------------------|-----------------|
| Locality | East Cannington |
| Local Government | City of Canning |

Department of Planning, Lands and Heritage

| | |
|-------------|--|
| File Number | |
|-------------|--|

Examination

| | |
|----------|------|
| Examined | Date |
|----------|------|

Planning Approval

| | |
|--------------------|--|
| Planning Authority | Western Australian Planning Commission |
| Reference | 162934 |

| | |
|------------------------------------|------|
| Delegated under S. 16 P&D Act 2005 | Date |
|------------------------------------|------|

In Order For Dealings

| | |
|------------|--|
| Subject To | |
|------------|--|

| | |
|------------------------------------|------|
| For Inspector of Plans and Surveys | Date |
|------------------------------------|------|

Plan Approved Reg. 26A (4)

| | |
|--|------|
| Inspector of Plans and Surveys / Authorised Land Officer | Date |
|--|------|

Survey Details

| | |
|---------------------------------|--------|
| Field Records | 160353 |
| Declared as Special Survey Area | Yes |

Survey Method Regulatory Statement

Survey carried out under Reg. 26A Special Survey Area Guidelines. See survey sheet(s) to determine the true final position and type of all survey marks placed for this plan.

Survey Method and Plan Content Variations

| Approved Variation Type | Reference |
|-------------------------|-----------|
|-------------------------|-----------|

Survey Certificate - Regulation 54

I, Nigel J. SIMPSON hereby certify that this plan is accurate and is a correct representation of the -
 (a) survey; and
 (b) calculations from measurements recorded in the field records, undertaken for the purposes of this plan and that it complies with the relevant written law(s) in relation to which it is lodged.

FINAL

| | |
|-------------------|------|
| Licensed Surveyor | Date |
|-------------------|------|

Survey Organisation

| | |
|-----------|--------------------------------|
| Name | MNG MCMULLEN NOLAN GROUP |
| Address | PO Box 3526, SUCCESS W.A. 6964 |
| Phone | 6436 1599 |
| Fax | 6436 1500 |
| Email | info@mngsurvey.com.au |
| Reference | 105241dp-006b |

Amendments

| Version | Lodgement Type | Amendment Description | Authorised By | Date |
|---------|----------------|-----------------------|---------------|------|
|---------|----------------|-----------------------|---------------|------|

Former Tenure

| New Lot / Land | Parent Plan Number | Parent Lot Number | Title Reference | Subject Land Description |
|-----------------|--------------------|--------------------------|---------------------|--------------------------|
| 1-4, 10, 11, 27 | P 2811 | Pt LOT 607 | 1290/705 | |
| 5-9, 13 | P 2811 | Pt LOT 608 | 1254/17 | |
| 15-26 | D 98788 | Pt LOT 22 | 2212/100 | |
| 12 | P 2811 P 2811 | Pt LOT 607 Pt LOT 608 | 1290/705 1254/17 | |
| 14 | P 2811 D 98788 | Pt LOT 608 Pt LOT 22 | 1254/17 2212/100 | |

New Interests

| Subject | Purpose | Statutory Reference | Origin | Land Burdened | Benefit To | Comments |
|---------|---------------------|--------------------------|-----------|---------------|-----------------|----------|
| B2 | EASEMENT (Drainage) | SEC 136C OF THE TLA 1893 | THIS PLAN | LOT 2 | LOT 1 | |
| B4 | EASEMENT (Drainage) | SEC 136C OF THE TLA 1893 | THIS PLAN | LOT 4 | LOT 27 | |
| B6 | EASEMENT (Drainage) | SEC 136C OF THE TLA 1893 | THIS PLAN | LOT 6 | LOT 7 | |
| B9 | EASEMENT (Drainage) | SEC 136C OF THE TLA 1893 | THIS PLAN | LOT 9 | LOT 8 | |
| B11 | EASEMENT (Drainage) | SEC 136C OF THE TLA 1893 | THIS PLAN | LOT 11 | LOT 12 | |
| B14 | EASEMENT (Drainage) | SEC 136C OF THE TLA 1893 | THIS PLAN | LOT 14 | LOT 13 | |
| B16 | EASEMENT (Drainage) | SEC 136C OF THE TLA 1893 | THIS PLAN | LOT 16 | LOT 15 | |
| B18 | EASEMENT (Drainage) | SEC 136C OF THE TLA 1893 | THIS PLAN | LOT 18 | LOT 17 | |
| B22 | EASEMENT (Drainage) | SEC 136C OF THE TLA 1893 | THIS PLAN | LOT 22 | LOT 21 | |
| B23 | EASEMENT (Drainage) | SEC 136C OF THE TLA 1893 | THIS PLAN | LOT 23 | LOT 24 | |
| A | EASEMENT | SEC 195 OF THE LAA 1997 | DOC | LOT 21 | CITY OF CANNING | |

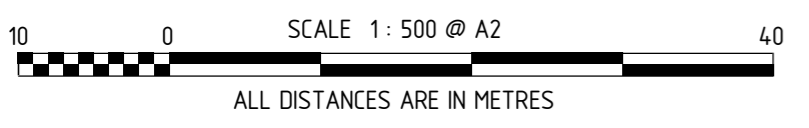
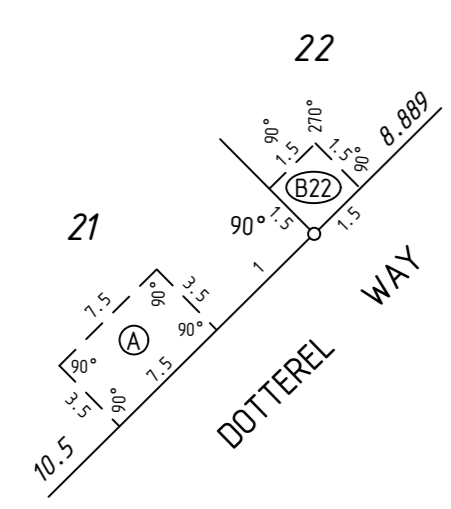
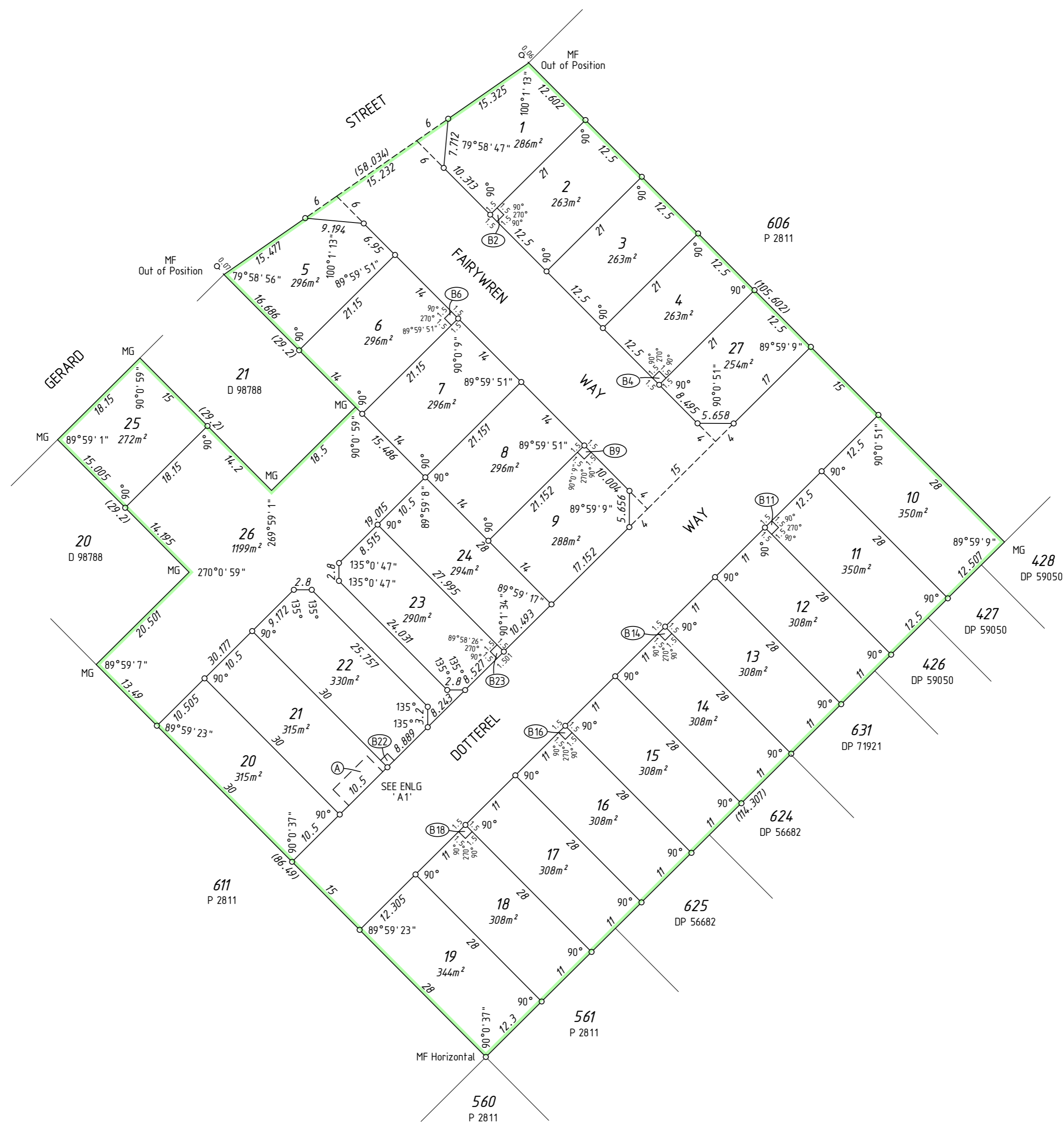

THIS SURVEY SHEET WILL BE
REPLACED BY THE SURVEY DATA



MC MULLEN NOLAN GROUP
PO Box 3526, Success W.A. 6964
Tel: (08) 6436 1500
Fax: (08) 6436 1500
Email: info@mngsurvey.com.au

MNG Ref : 105241dp-006b

VERSION NUMBER

1

DEPOSITED PLAN
427110